

1 HYDEPARK ROAD SECTION 1
SCALE 1: 100

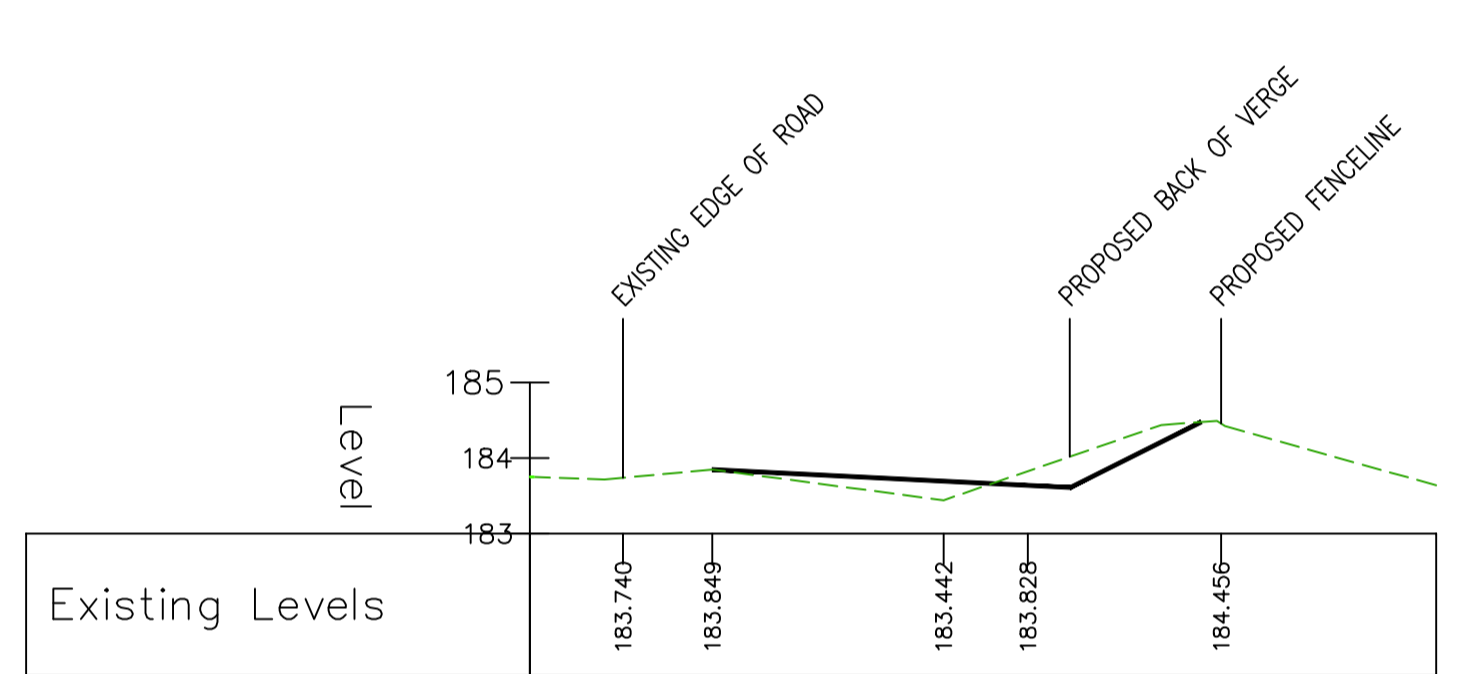

2 HYDEPARK ROAD SECTION 2
SCALE 1: 100

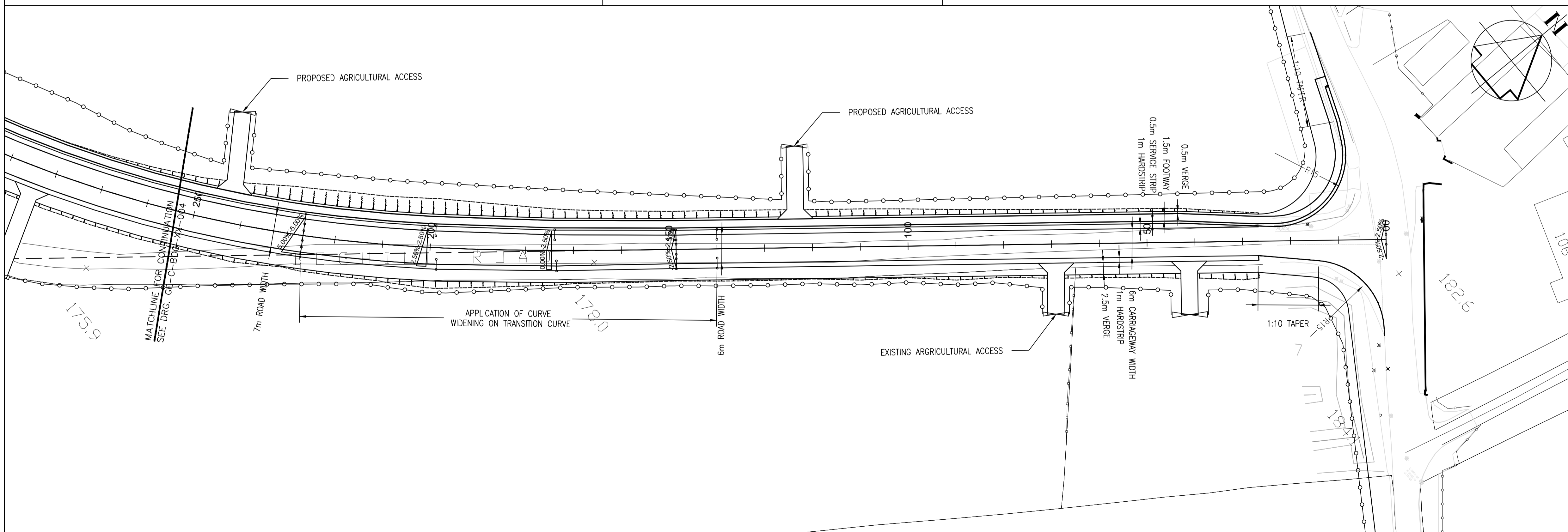

PROPOSED BOGHILL ROAD PLAN (0m-250m)
(SCALE 1:500)

- Notes**
1. THIS DRAWING IS TO BE READ IN CONJUNCTION WITH ALL OTHER HIGHWAY, DRAINAGE AND SERVICE DRAWINGS
 2. ALL DIMENSIONS ARE IN METRES UNLESS OTHERWISE NOTED
 3. DESIGN SPEED FOR BOGHILL ROAD IS 100A
 4. PRIORITY JUNCTIONS DESIGNED IN ACCORDANCE WITH TD42/95
 5. ROAD MARKINGS AND TRAFFIC SIGNAGE ARE TO BE IN ACCORDANCE WITH TRAFFIC SIGNS REGULATIONS AND GENERAL DIRECTIONS 2005 - ALL ROAD SIGNS TO BE PASSIVELY SAFE
 6. ALL WORKS ARE TO BE CARRIED OUT IN ACCORDANCE WITH HIGHWAYS AGENCY MANUAL OF CONTRACT DOCUMENTS VOLUME 1 "SPECIFICATION FOR HIGHWAY WORKS" AND VOLUME 3 "HIGHWAY CONSTRUCTION DETAILS"
 7. THE POSITION OF EXISTING SERVICES SHOWN ON THE DRAWINGS IS INDICATIVE ONLY - THE CONTRACTOR SHALL LOCATE THE EXACT POSITION OF EXISTING SERVICES IN THE AREA OF THE WORKS IN ADVANCE OF COMMENCEMENT OF THE MAIN CONSTRUCTION WORKS
 8. WIDENING ON CURVES HAS BEEN PROVIDED, 0.5m PER LANE, FOR RADII BETWEEN 150m AND 300m AS PER TD9/93 CL. 3.11

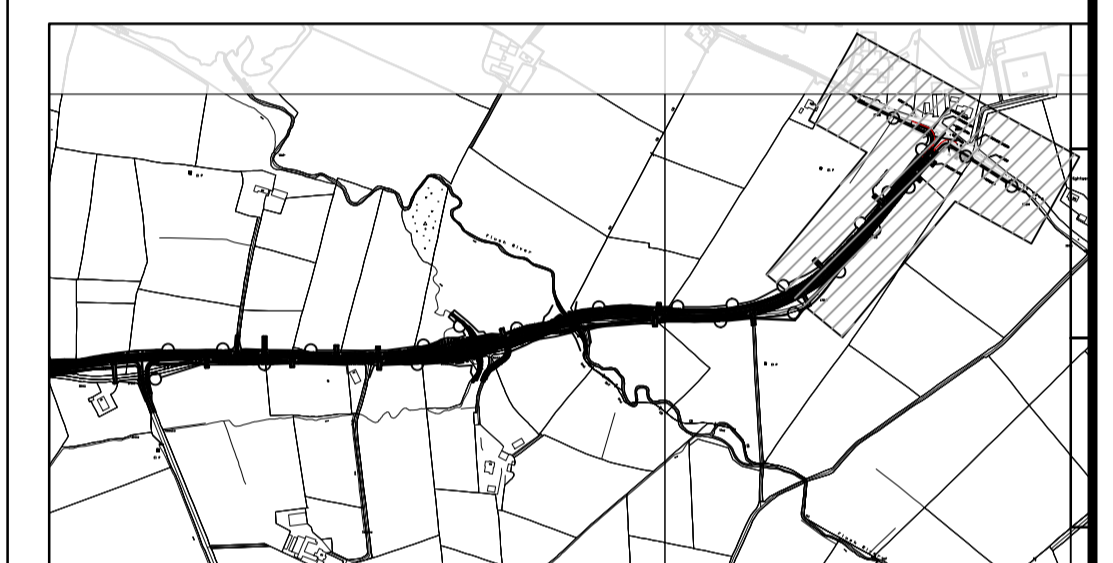

KEYPLAN
(NTS)

Key to symbols

- PROPOSED FENCE
- EXISTING FENCE
- EXISTING WALL
- GATE
- EXISTING PROFILE
- PROPOSED PROFILE
- PROPOSED KERB LINE

Rev	Date	Drawn	Description	Ch'k'd	App'd
A	25/07/14	ML	FOR INFORMATION	MK	SW



Client

arc21
Walsh House
Fortwilliam Business Park
35 Dargan Road
Belfast BT3 9LZ

Title

ARC 21 RESIDUAL WASTE TREATMENT PROJECT
PROPOSED HYDEPARK ROAD & BOGHILL ROAD LAYOUT SHEET 1 OF 3

Designed	MK	13/08/12	Eng.Chk.	ACK	13/08/12
Drawn	SV	13/08/12	Coordination	DMcF	13/08/12
Dwg.Chk.	MK	13/08/12	Approved	SW	13/08/12
Scale @ A1	Project 5090959		Status		T
1: 500		CAD file GE-C-BOG-XX-003-A.dwg		Rev A	
Drawing No. GE-C-BOG-XX-003					Rev A