

1 HYDEPARK ROAD SECTION 1
SCALE 1: 100

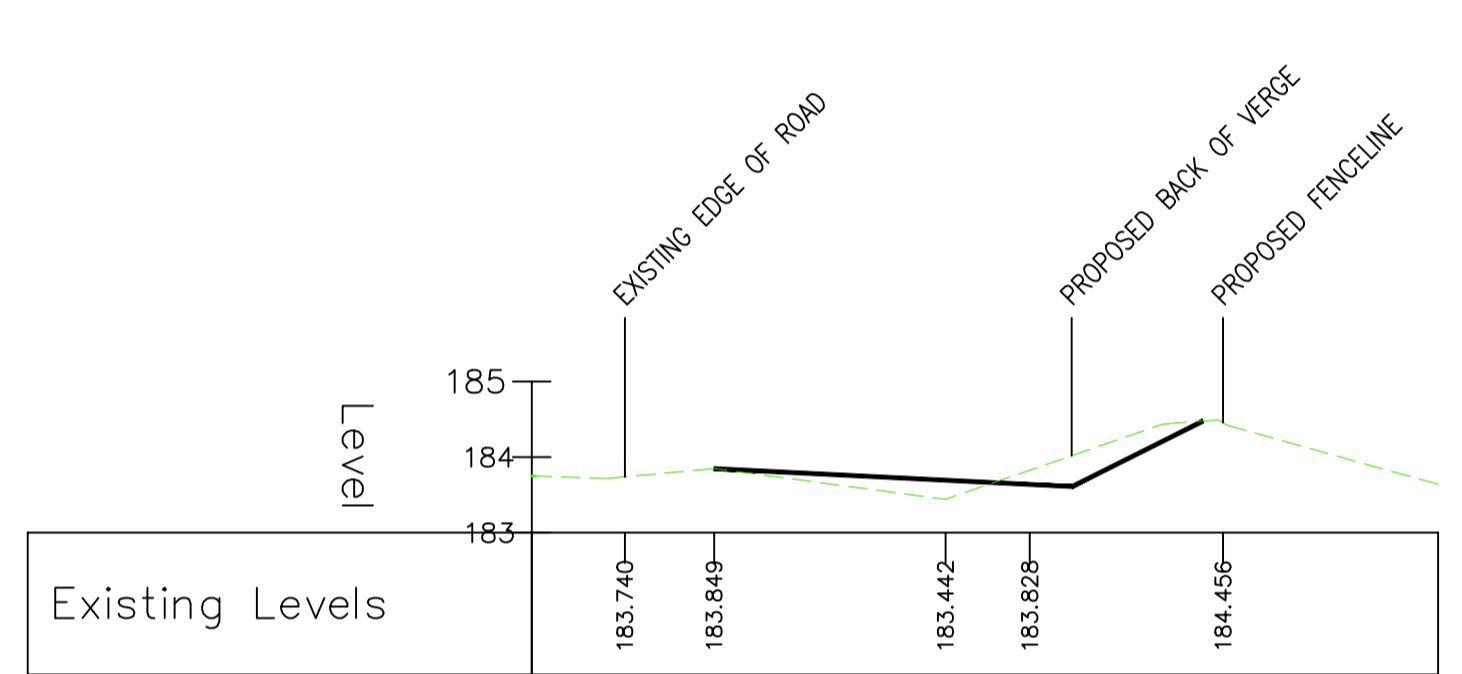

2 HYDEPARK ROAD SECTION 2
SCALE 1: 100

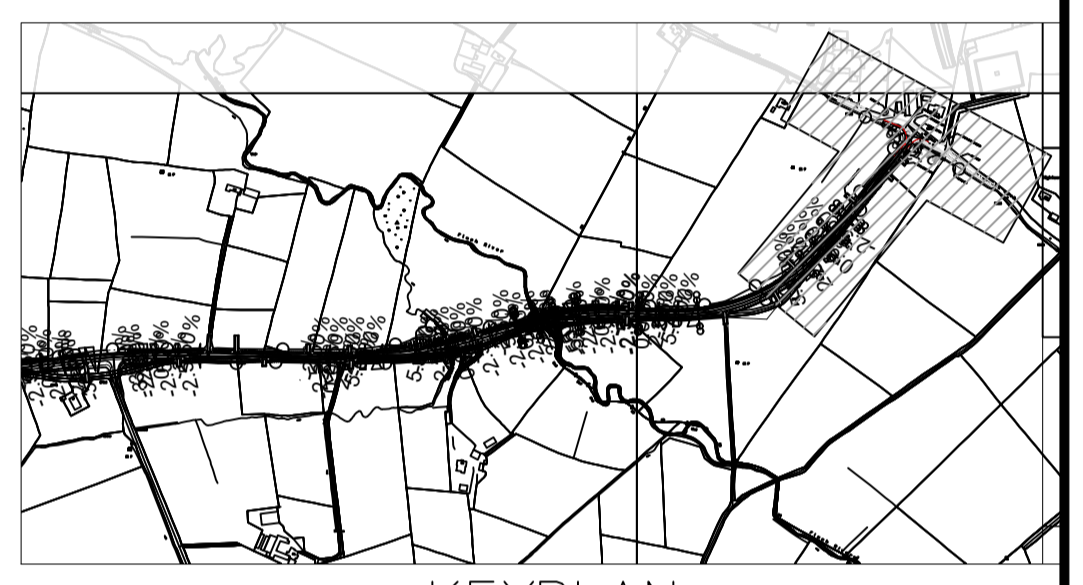

KEYPLAN
(NTS)

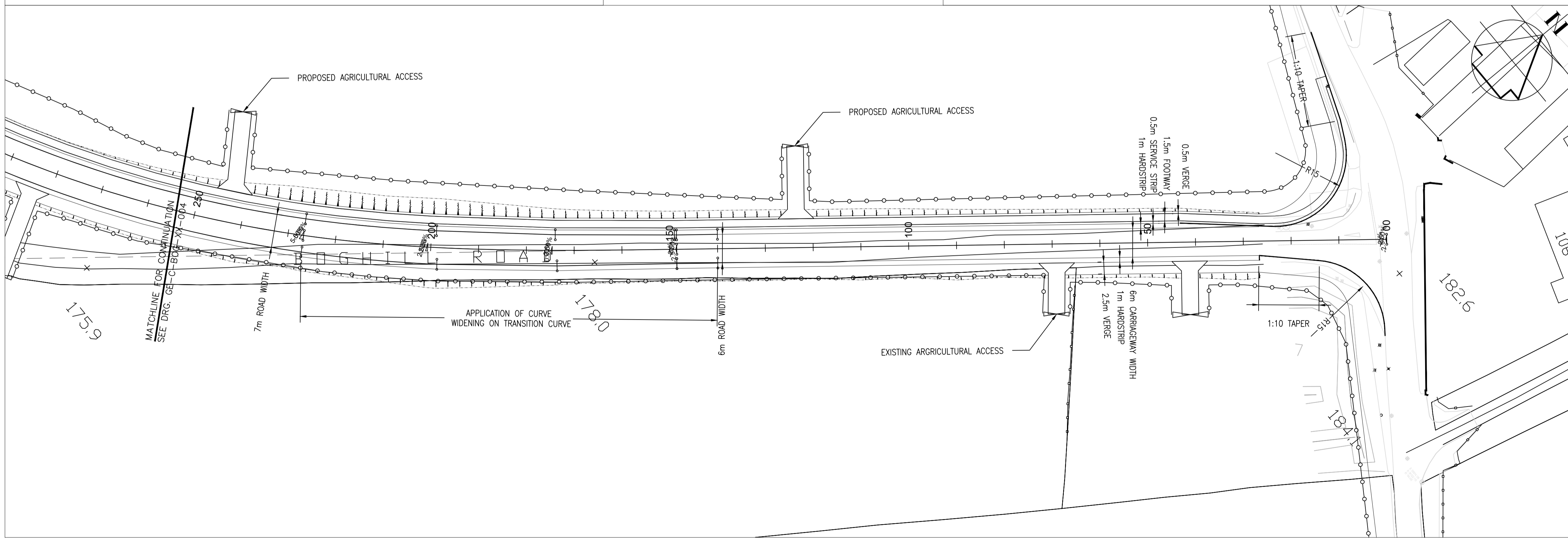

PROPOSED BOGHILL ROAD PLAN (0m-250m)
(SCALE 1: 500)

- Notes
1. THIS DRAWING IS TO BE READ IN CONJUNCTION WITH ALL OTHER HIGHWAY, DRAINAGE AND SERVICE DRAWINGS
 2. ALL DIMENSIONS ARE IN METRES UNLESS OTHERWISE NOTED
 3. DESIGN SPEED FOR BOGHILL ROAD IS 100A
 4. PRIORITY JUNCTIONS DESIGNED IN ACCORDANCE WITH TD42/95
 5. ROAD MARKINGS AND TRAFFIC SIGNAGE ARE TO BE IN ACCORDANCE WITH TRAFFIC SIGNS REGULATIONS AND GENERAL DIRECTIONS 2005 - ALL ROAD SIGNS TO BE PASSIVELY SAFE
 6. ALL WORKS ARE TO BE CARRIED OUT IN ACCORDANCE WITH HIGHWAYS AGENCY MANUAL OF CONTRACT DOCUMENTS VOLUME 1 "SPECIFICATION FOR HIGHWAY WORKS" AND VOLUME 3 "HIGHWAY CONSTRUCTION DETAILS"
 7. THE POSITION OF EXISTING SERVICES SHOWN ON THE DRAWINGS IS INDICATIVE ONLY - THE CONTRACTOR SHALL LOCATE THE EXACT POSITION OF EXISTING SERVICES IN THE AREA OF THE WORKS IN ADVANCE OF COMMENCEMENT OF THE MAIN CONSTRUCTION WORKS
 8. WIDENING ON CURVES HAS BEEN PROVIDED, 0.5m PER LANE, FOR RADII BETWEEN 150m AND 300m AS PER TD9/93 CL. 3.11

Key to symbols

	PROPOSED FENCE
	EXISTING FENCE
	EXISTING WALL
	GATE
	EXISTING PROFILE
	PROPOSED PROFILE
	PROPOSED KERB LINE

Rev	Date	Drawn	Description	Ch'k'd	App'd
B	11/01/19	RW	FOR INFORMATION	MK	MM
A	25/07/14	ML	FOR INFORMATION	MK	SW



Client
arc21
 arc 21
 Walsh House
 Fortwilliam Business Park
 35 Dargan Road
 Belfast BT3 9LZ

Title
 ARC 21 RESIDUAL WASTE TREATMENT PROJECT
 PROPOSED HYDEPARK ROAD & BOGHILL ROAD LAYOUT SHEET 1 OF 3

Designed	MK	13/08/12	Eng.Chk.	ACK	13/08/12
Drawn	SV	13/08/12	Coordination	DMcF	13/08/12
Dwg.Chk.	MK	13/08/12	Approved	SW	13/08/12
Scale @ A1	1: 500		Project	5090959	Status
Drawng No	GE-C-BOG-XX-003		CAD file	GE-C-BOG-XX-003-B.dwg	T
Rev	B				